

Y-Ball Bearings with Integral Adapter Sleeve

UH 209/30 2T.SH

Y-Ball Bearings with Integral Adapter Sleeve

Harvester

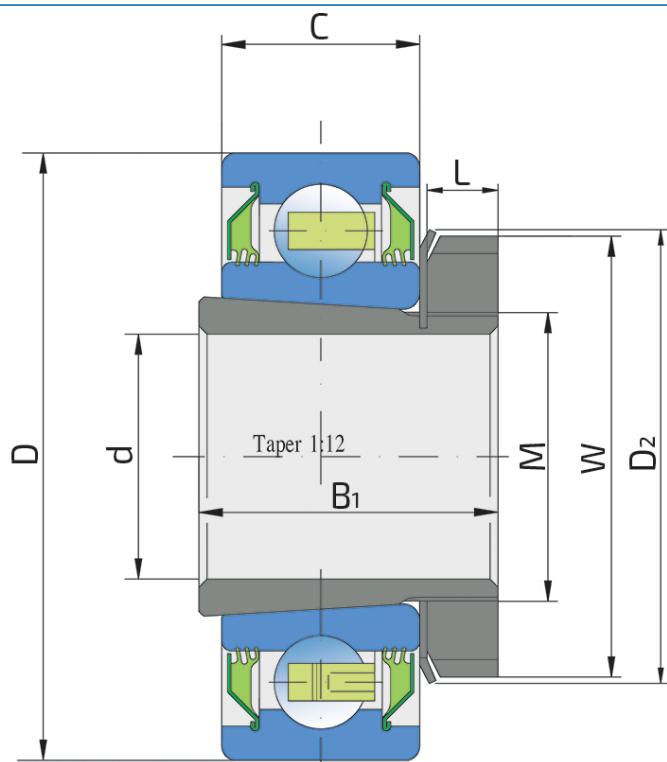

Technical Specification

| | | |
|------|----------------------------|-----------|
| d | Bore diameter | 30 mm |
| D | Outside diameter | 85 mm |
| W | KM nut outside diameter | 52 mm |
| D2 | MB Washer outside diameter | 57 mm |
| B1 | Width adapter sleeve | 35 mm |
| C | Width outer ring | 23 mm |
| L | KM nut width | 8 mm |
| M | Thread adapter sleeve | 35x1.5 mm |
| kg | Mass | 0.7 kg |
| Cdyn | Dynamic load rating | 33.2 kN |
| Co | Static load rating | 21.6 kN |
| Pu | Fatigue load limit | 0.91 kN |

Sealing

T SEAL / T SEAL (2T)

3-lip seal on the both side of the bearing, provides equal protection against contamination. Recommended for application where the possibility of contamination is the same on the both side.

